

User's Manual

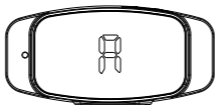
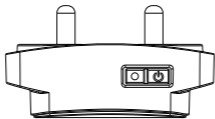

A13 No Bark Collar

0.3.0.02.A13000-14-10

Please read the user's manual before beginning.

Thanks for purchasing!

The A13 No Bark Collar is designed to make dogs live safely, happily and get along with people more harmoniously.

⚠️ WARNING Do not use it with aggressive dogs.

Aggressive dog's can cause severe injury and even death to their owner and others. If you are unsure whether this product is appropriate for your dogs, please consult your veterinarian or certified trainer.

⚠️ CAUTION Safety during on-leash training.

It is vitally important that you and your dog remain safe while learning during on-leash training. Your dog should be on a strong leash, long enough for him to attempt to chase an object, but short enough for him not to reach a road or other unsafe area. You must also be physically strong enough to restrain your dog when he tries to chase.

CAUTION Risk of skin damage.

Please read and follow the instructions in this manual. Proper fit of the collar is important. A collar worn for too long or made too tighten the pet's neck may cause skin damage ranging from redness to pressure ulcers. This condition is commonly known as bed sores.



- Avoid leaving the collar on the dog for more than 12 hours per day. When possible reposition the collar on the pet's neck every 1 to 2 hours.

- Never connect a lead to the electronic collar; it will cause excessive pressure on the contacts.
- If a rash or sore is found, discontinue use of the collar until the skin has healed.
- If the condition persists beyond 48 hours, see your veterinarian.
- This product is not a toy, please keep away from children.
- This product is only for use with healthy dog.

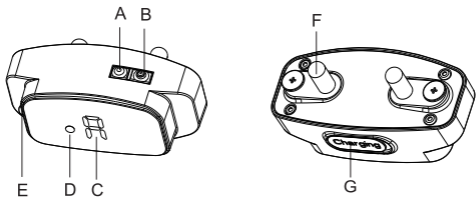
Overview



- A . Shock setting button
- B . On/Off Button/Level Button
- C . Shock Level display screen
- D . Red/Green LED
- E . Microphone
- F . Contact Points
- G . Charging Port (with cover)

	<p>In the shutdown mode, short press to power on. In standby mode, press and hold 3S to turn off the power. Short press to adjust the sensitivity of trigger.</p>
	<p>In standby mode, Short press to adjust the shock intensity level. Long press for 3 seconds to enter the test mode.</p>
<p>Screen Display</p>	
<p>0-7</p>	<p>“0” means vibration mode. and “1-7” means electric shock intensity from low to high. (In the sensitivity adjustment state, the screen displays “1-5” indicating that the sensitivity level of the collar is from low to high.)</p>
<p>A</p>	<p>(A) It automatically adjusts the shock level/vibration/sound according to the pet's voice and frequency.</p>
<p>t</p>	<p>(t) Indicates that the collar is in test mode.</p>

Setting Up the Product

Before you can use this Collar, you must set up the product as below steps:

1. Charging the Collar.
2. Prepare the Collar .
3. Function test, test function before wearing it on dog.

Charging the Collar

1. For the initial charging it, make sure to charge it for 4 hours. Subsequent charges only take 2-3 hours.
2. When full charged, the red LED will turn to green.
3. Please replace the rubber cover when the Collar is full charged.

Tips:

1. Excessive charging will shorten battery life. Only charge them when batteries are low.
2. When you're not using the collar, please turn it off to increase the battery life.

Note:

Please use the Output:DC 5V 500-2000mA charger to charge the product.

Don't use a charger that does not meet the specifications to charge the product.

Prepare the Collar

Turn on the Collar

- Press the  Button the screen comes on.
- The screen will display the last user-set level by default.

Turn off the Collar

Press and hold the  Button until the screen comes off.
(This takes approximately 3 seconds).

Assembly the Collar

Refer to the figure below to assemble the rope and collar.

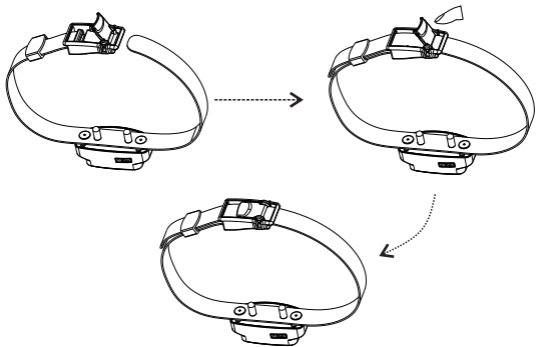

Function Test

We recommend that you perform a functional test before using the A13 collar.

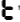
1. Long press the shock setting button for 3 seconds to enter the test mode, the screen display “” flashes.

2. To facilitate testing, place the test light on the contact points and shout "WO, WO" to the microphone.

The collar will emit sound, vibration and shock at the same time, and the test light will be on, indicating the function is normal.

Press any key or 60 seconds without operation, the test mode will be exited.

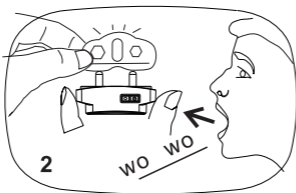
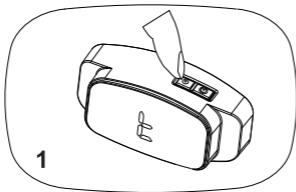

Collar Fitting

Please fit the collar properly so that the Contact Points press firmly against the dog's skin. When properly fitted, you should be able to put a finger in between the Collar and dog's neck.

Too loose:

The Collar will move around the dog's neck, the Contact Points may hurt the dog's skin.

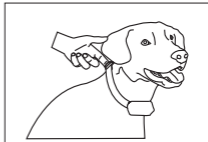

Too tight:

It may cause dogs to breathe hard.

Caution:

1. Do not shave the pet's neck as this may increase the risk of skin irritation.
2. The collar should not be worn for more than 12 hours per day. Or it may cause skin irritation.

Device Information

Product Specification

Battery Type	Rechargeable, lithium polymer battery
Battery Life(typical use)	8 days
Waterproof	IPX5.
Operating temperature	From 0-40°C(from 32-104°F)

The unit need to be charged under any of below situations

1. The indicator lighten on the Receiver Collar is emitting a red color every 4 seconds or flashes rapidly.
2. The screen does not display anything.

Others

Frequently Asked Questions

Is the beep/Shock safe for my pet?	While the beep/Shock is unpleasant, it is harmless to your pet. Electronic training devices require interaction and training from the owner to achieve desired results.
Suitable Size	Pets should be at least 6 months old before using the Collar.
Once my pet is trained and do not bark no long, will he have to continue to wear the Collar?	Probably not. You probably need to reinforce training with the Collar when it happens again. It's not just for barking but all wrong behaviors.
Does the collar beep/ Shock to my pet all the time if he do not stop barking?	No, in the 80 seconds underwear collar work up to 10 times in a row. If the 80-second underwear collar can't stop the barking, the collar will stop working for 1 minute, and the time will be re-timed after 1 minute. Prevent pets from getting hurt.
Is the Collar waterproof?	Can withstand rain but can not be soaked in water.

Troubleshooting Guide

My dog keeps barking all the time and the collar seems does not work.	<ul style="list-style-type: none">• Make sure the Collar has been turned on.• The battery(s) may be low in Collar, recharge it.• Collar 's Contact Points are too loose. Refer to "Collar Fitting" for more information.
The Collar will not turn on.	Make sure the Collar has been charged. For the initial charge, be sure to charge it for 4 hours. Subsequent charges only take 2-3 hours.
The collar is not holding a charge.	<ul style="list-style-type: none">• When the collar is charging, the screen will display "C". If not, check the power and charging cables.

Warranty and repair information

1-Year Limited Lifetime Warranty

The original purchaser for this unit is provided with 1-year warranty. it begins from the date of purchase. For the first year, coverage is for both Parts and Labor on warranty repair services.

Accessories such as straps and batteries are covered for the first year only. After the first year, the Limited Lifetime Warranty covers Parts only and does not cover Labor Fees and Accessories. All shipping fees incurred, the cost of Accessories after the first year, and Labor fees associated with out of warranty repair work, are the customer's responsibility. Labor fees will be variable depending on the extent of the work required. The Limited Lifetime Warranty expires 5 years after a model is discontinued from production.

To Qualify for the Warranty

All products must provided a proof of purchase is required to initiate repair work under warranty. We strongly recommend keeping the original receipt. If a proof of purchase is not available at the time of service, we will estimate the age of unit by the serial number. Serial number estimates can differ from the actual purchase date. A serial number estimate is the only method of determining an approximate date of purchase without a proof of purchase.

Not Covered Under Warranty

We DO NOT offer warranty for products that have been bought secondhand or as a resold product. We DO NOT replace defective units or provide refunds for products purchased from us after 30 days from the date of purchase. Issues of replacement and refunds on units purchased less than 30 days from an authorized dealer must be addressed to the dealer directly. If the products purchased from an

authorized dealer are after 30 days from the date of purchase, please send the units to us for service and repair. We DO NOT cover the cost of repairs and replacements due to misuse by the owner or dog, improper maintenance, and/or lost units. Any water damage on the Water Resistant remote and the Water Resistant Receiver of our product series will not be covered. All replacement costs for either the remote or receiver will be the owner's responsibility. The warranty is void if the unit has been altered or an unauthorized person has damaged the unit while attempting repair work. We reserve the right to retain and discard any parts or accessories that have been found damaged upon replacement and repair.

Procedure for Repair Work

If the unit is malfunctioning, please refer to the "Troubleshooting Guide" in the quick start before sending it back for Service. The cost of shipping products under warranty back is the customer's responsibility. We are not responsible for units damaged or lost in transition. We are not responsible for loss of training time or inconvenience while the unit is in for repair work. We do not provide any form of compensation during the repair period. A copy of the sales receipt showing the purchase date may be required before warranty work is initiated. Please include a brief explanation outlining the problem and include your name, address, city/state/zip code, phone number, and email address.

Compliance

FCC - USA

This device complies with part 15 of the FCC Rules.

Operation is subject to the following two conditions:

- (1) This device may not cause harmful interference.
- (2) This device must accept any interference received, including interference that may cause undesired operation.

CAUTION: Modification or dismantling to this equipment not expressly approved by Manufacture may void the user's authority to operate the equipment.

Note: This equipment has been tested and found to comply with the limits for a Class B digital device, pursuant to part 15 of the FCC Rules. These limits are designed to provide reasonable protection against harmful interference in a residential installation. This equipment generates uses and can radiate radio frequency energy and, if not installed and used in accordance with the instructions, may cause harmful interference to radio communications. However, there is no guarantee that interference will not occur in a particular installation. If this equipment does cause harmful interference to radio or television reception, which can be determined by turning the equipment off and on, the user is encouraged to try to correct the interference by one or more of the following measures:

-Reorient or relocate the receiving antenna.

- Increase the separation between the equipment and receiver.
- Connect the equipment into an outlet on a circuit different from that to which the receiver is connected.
- Consult the dealer or an experienced radio/TV technician for help.



Shenzhen Patpet Technology Co.,Ltd

 <https://patpet.com/>

 Become a dealer: inquiry@patpet.com

 After-service: support@patpet.com

 [@PatpetDogCollar](#)

 Youtube Video Guide



MADE IN CHINA